



SPARES SERVICE

Members Price List

Edition 2

November 2017

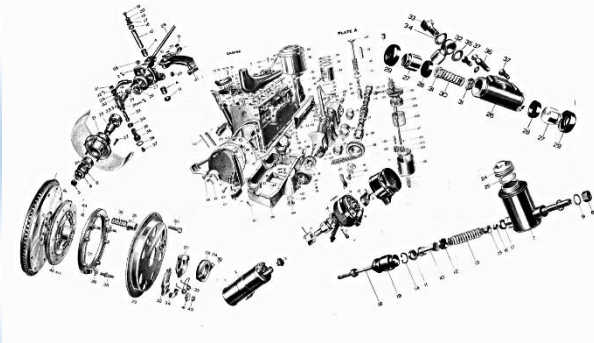

Copies of this booklet can be downloaded from the spares website



The Club for Morris Vehicles designed before 1940



For more information on joining the Morris Register visit

morrisregister.co.uk/join/

morrisregisterspares.co.uk

Morris Register Membership Provides

- A copy of the club **Magazine** each month.
- Access to the Club **Spares Service**.
- National, Regional and Local **Events**.
- Access to the member's area of our **Website** including extensive archives, on-line **Forum**.
- Access to a wealth of **Knowledge** and experience from other members

Contents

Axle & Steering.....	3	Engine-Tappet Screws	12
Bearings	5	Cylinder Head Studs	13
Wheel Bearing Kits	5	Engine-Timing Chains	14
Individual Wheel Bearings.....	5	Valve Guides.....	14
Gearbox Bearings & Bushes	6	Valve Springs	14
Differential Bearings	6	Engine-Valves	15
Clutch Bearings	6	Oils	16
Brake Linings	7	Fuel Pump	16
Brake Cylinders, Springs & Seals.....	7	Carburettor	17
Brake Hoses	8	Head Gaskets	18
Brake Fixings	9	Manifold Gaskets	18
Cooling -Hoses	9	Other Engine Gaskets	19
Cooling-Fan Belts	10	Ignition	20
Electrical	10	Suspension	21
Engine & Gearbox Mounts	11	Transmission	22
Oil Pump	11	Various Parts	22
Engine Shells & Rods	12	How to purchase spares	24
Engine-Studs, Bolts Nuts & Washers	12	Spares Identification Help Charts	25

Axle & Steering

Part No	Description	Price
UB008	U Bolts set of 4 Rear Morris 8 1934-1938, late Minor Set of 4 with nuts and half nuts	£13.50
UB010	U Bolts Rear Morris Late Pre-series 10/4, 10/6, S2 10/4, 12/4 Set of 4 with nuts and half nuts	£17.40
UB009	U Bolts Rear Morris 8 Series E, Z van 1938-1953 Set of 4 with nuts and half nuts	£13.50
WK002	Rear Wheel Bearing Kit Morris 8 Early (screw in wheel studs)	£36.00
BB009	Bearing Steering column 1925-30 OXFORD 1925-30 OXFORD FWB, COWELY 1923-33	£10.39
hS255	Rear Hub oil seal HS255	£5.04
HS411	Front Hub oil seal 10/4, 12/4 S2	£7.92
HS155	Rear Hub Seal HS155	£5.04
C352	Front hub oil seal Morris minor OHV and SV 1931-1943	£12.24
HG002	Rear Hub Flange Gasket later M8, SE, Z Van	£1.69
HG001	Rear hub gasket, M8 flanged studs	£1.69
BB628	Morris 8 SE, Minor, 10/4, 12/4, 14 S111 Rear Hub Bearing	£9.60
TR826	Drag link pair, Morris 8 SE	£89.76
TR172	Track rod ends pair (LH and RH) including lock nuts, All Morris 8s, Series 10M	£44.99
TR172a	Track rod ends pair (LH and RH) NOS, All Morris 8s, Series 10M (no lock nuts)	£39.99
BT001	Track rod end rubber boot; non original replaces the felt washer	£1.25
TR085	Track Rod End, Series Y Van. Pairs	£15.72
KP172	King pin set. Bimetal bushes, no flange, M 8 no. 102807;	£89.76
KP080	King pin set Bushes flanged (top hat type), 1934 Minor, Early M 8	£92.16
KP079	King pin set Minor- after chassis 34699 (no brake pulley)	£89.76
KP005	King pin Pre-Series 10/4- 10/6- 12/4, 15/6, Cowley 22-33,	£92.40
HS010	Minor rear hub oil seal	£14.20
FS001	M8 front hub seal.	£7.57

morrisregisterspares.co.uk

Axle & Steering continued

Part No	Description	Price
OS239	Rear axle shaft seal, Most C and CS commercials	£1.24
OS006	Felt seal 1/2" I/D x 1.3/8" O/D x 1/4" thk, dust seal for all early type track rod ends	£1.84
HS291	Rear hub lip seal, Rear Hub all M8. 10/4 & 12/4 Series 2 1935 -37.	£10.57
HS272	Rear Hub lip seal 1.7/8" ID x 2.625" ID x 3/8" thk, Rear Hub 1946-48 Morris 8E	£7.92
HS155	Rear Hub lip seal. 1.7/8" ID x 2.44" x 19/64" Rear hub Morris 10/4- 12/4 1937 on, series 1,2,3	£14.52
HS005	Nylatron (replaces cork) seal axle half shaft, Minor and series 2 10/4 Pairs, handed.	£14.40
HS004	Felt seal, Front Hub outer 8- 8E; S2-3 10/4, 12/4; 14/6; 10M;	£2.11
HS003	Felt seal 1.21/32" ID x 2.1/4" OD x 9/32" thk, Front Hub inner Minor and all Morris 8.	£2.11
HS002	Rear Hub bearing Felt seal, Rear Hub all Morris 8. 10/4 & 12/4	£2.11
HS001	Nylatron (replaces cork) seal for half shaft, M8, SE, Z. Pairs.	£14.40
SW003	Wheel stud, Later M8, 8SE, 10M front.	£3.60
SW001	Wheel Stud Morris Eight S1& S2; S2 10/4, 12/4 Front.	£0.60
SW002	Rear wheel studs, Morris 8 1935-37	£1.00
NW002/70	Wheel Nut 3/8BSF x 70 degree, 8E and 10M	£4.92
NW002/60	Wheel Nut 3/8BSF x 60 degree, 32-34 SV Minor- M8- 35-38 10/4 S2 ,3, 12/4 S2 3,10cwt	£4.32
NW001	Wheel nuts, brass, 10/4- 12/4, most over 8hp models pre-series	£5.76
RH001	Retaining nuts for rear hub bearing -LH and RH thread, pair for Minor, all 8s, Series	£16.50
MB008	Tab Washer. 40 mm I/D Retains hub or diff nut, Minor- 8- 10, 12, 14 40mm i/d rea	£1.00
MB045	Tab Washer. 45 mm I/D Retains hub or diff nut, Any car with 45mm i/d rear hub bearing	£1.19
NG545	Grease nipple 5/16" BSF 45 degree, clip-on type	£1.32
NG500	Grease nipple 5/16" BSF straight, clip-on type	£0.79
NG445	Grease nipple 1/4" BSF 45 degree, clip-on type	£1.32
NG400	Grease nipple 1/4" BSF straight, clip-on type	£0.79

morrisregisterspares.co.uk

Bearings (See Axles & Steering for bearing seals, nuts & washers)

Wheel Bearing Kits

Part No	Description	Price
WK001	Front Wheel Bearing Kit Morris 8, SE & Z Van, includes seals	£12.60
WK002	Rear Wheel Bearing Kit Morris 8 Early (screw in wheel studs), includes seal, gasket & tab washer	£36.00
WK003	Rear Wheel Bearing kit Morris 8 late, Press in wheel studs includes seal, gasket & tab washer	£36.00
WK004	Rear Wheel Bearing kit Series E, includes seal, gasket and tab washer	£14.00

Individual Wheel Bearings

BB624	Front hub bearing outer Family 8 Minor	£4.80
BB625	Front wheel bearing inner; M8, SE & Z van, Minor 1928-32. Rear gearbox SE	£3.60
BB625S	Wheel bearing Front inner (sealed) Minor 1928-29, M8, SE, Z van	£3.60
BB626	Morris 10 1933-34 front hub inner bearing	£6.00
BB628	Morris 8 SE, Minor, 10/4, 12/4, 14 S111Rear Hub Bearing	£9.60
BB628S	Rear hub bearing (sealed) SE, 10/4 1935-48, 12 S11 1935-40, 14 S1, 11 1937-40	£10.30
BB634	Front wheel outer bearing, Morris 8, SE, Z, Morris 10/4 all 1932 to 10 SM	£3.60
BB634S	Bearing (sealed) Front wheel outer: M8, SE, Z van. 10/4 1932-1954 35, 10 S2 & S3, 10 Series M	£4.08
BB428S	Morris 8 S1/2 Rear Hub Bearing (sealed)	£32.30
BB636	Front Inner hub bearing, Morris 10/4 1932-35, 14 S3	£9.60
BB305	Cowley 1923-1933 front outer hub bearing	£14.99
BB635	Rear wheel bearing Sealed; Morris 10/4 S2&3, 10M,	£14.52

morrisregisterspares.co.uk

Gearbox Bearings & Bushes

Part No	Description	Price
BG625	Morris 8 1934-38 Gearbox main shaft snap ring bearing 2 required	£15.54
BB307	Gearbox Main shaft bearing, Minor 1928-1933	£15.18
BG208s	Series E Gearbox main shaft snap ring bearing 2 required (sealed bearing aids oil retention)	£16.20
BB625S	Series E 1938-1948, Rear gearbox (sealed bearing aids oil retention)	£3.60
BH001	Series E 1938-1948 Gearbox input shaft bush, fits in end of crankshaft	£1.68
BH002	M8 & SE Z van Layshaft bush. 2 required	£2.64

Differential Bearings

BB210	Morris 10 35-48 diff constant mesh pinion bearing	£18.00
BN306	Morris 14 S111 Bevel Pinion Bearing, N306 or MRJ30,	£36.32
BB635	Morris 8 Outer diff pinion	£14.52
BT706	Crown Wheel & Pinion bearing; Cowley 1023-1933	£21.60
BT707S	LJT35, M8 Differential	£6.96
BT718	Differential Bearing 11.9 & 14/32 4-cyl Major Six Oxford Six 1928-9, 1/LJT40	£42.24
BT708	Morris 14 S111 Diff bearing 37-40	£16.80

Clutch Bearings

BB205S	Morris 8 Clutch Spigot Bearing (Sealed)	£4.26
BB132	10/4 & 10 S111 Clutch Spigot bearing	£21.60
BT707S	Clutch release 10/4 S11 & Ten S111 (sealed bearing)	£6.96
BT712	Minor Clutch Withdrawal Bearing	£24.00
BB205S	Morris 8 Clutch Spigot Bearing (Sealed)	£4.26
CP001	Clutch release bearing carbon Morris 8 all models	£18.00

morrisregisterspares.co.uk

Brake Linings -All supplied with rivets

Part No	Description	Price
MG031	Brake Linings Minor 1929-1933; 5cwt light van 1933-1934	£19.99
MO151	Brake lining axle set, 1932-34 Cowley- Major- 10/4, 12/4 10/6,14/6	£19.99
MO261	Brake lining axle set with rivets.1934 Minor and all 8's 1935 to 1953	£19.99
MO271	Brake lining axle set -with rivets, 1935-48 10/4- 12/4 Series 2 & 3- 10M	£19.99
WO172	Brake lining axle set; 4 linings with rivets.1932 Family 8	£19.99
WO241	Brake lining axle set 1935 Pre-series 10/4-10/6- 12/4, 15/6 steel shoes; 14/6 Ser. 2 & 3	£19.99
TB001	Brake lining rivet punch tool	£12.70

Brake Cylinders, Springs & Seals

BM001	Master cylinder with extension tube & seals. 3 1/4 inch can, Morris 8 Series 1 & 2	£261.42
BM002	Brake master cylinder adaptor 1/2" diameter shaft, Morris 8	£28.09
BM003	Brake master cylinder- Morris 10/4 & 12/4, 1936 - 1939	£258.00
BM004	Brake master cylinder 36-1939 Morris 14/6, 16, 18, 21, 25 Series II & III	£256.80
BM005	Brake master cylinder1939 -1947 Morris 10	£258.48
BM006	1934 1935 Morris 10/4 & 12/4: Oxford /Cowley, Brake master Cylinder	£260.82
BM007	Master cylinder with extension tube & seals. Morris 8 series E	£261.42
BP004	Wheel Cylinder inner spring , 1.1/4" wheel cylinders	£5.76
BP010	Hose to wheel cylinder adaptor 1/2" x 20tpi thread, 1/2" x 20 tpi Pre-S 10/4- 12/4-6,etc	£7.26
BP101	Wheel Cylinder spring all 8s (tapered no requirement for crown washers)	£5.04
BP102	Wheel Cylinder inner spring, Minor 1" Cylinders (tapered no requirement for crown washers)	£5.76

morrisregisterspares.co.uk

Brake Cylinders, Springs & Seals continued

Part No	Description	Price
BP103	Cylinder Spring 1.1/8 cylinders (tapered no requirement for crown washers)	£5.76
BR309	Wheel cylinder kit 51309, 10/4 s2 & 3- 12/4 s2- 10 SM rear	£6.18
BR429	Wheel cylinder kit 55287, 10/4 s2 & 3- 12/4 s2- 10 SM, front	£10.79
BR569	Master cylinder kit Family 8 Minor- 10/4- 12/4 Ser2/3, 10M, Y van	£11.22
BR599	Master cylinder kit 1.1/4", 10/4- 10/6- Cowley 4 & 6, 12,14 to 25	£8.40
BR605	Wheel cylinder kit 50605, 10/4- 10/6- 12/4, 15/6	£7.30
BR631	Wheel cylinder kit 50631, 10/4- 10/6- Cowley 4 & 6	£5.68
BR675	Master cylinder kit 7/8", 1934 Minor- M8- M8E	£9.24
BR679	Wheel cylinder Kit 7/8", M8-8E (set for a wheel cylinder)	£7.20
BW100	Rear wheel cylinder; 10 series M & 12	£56.40
BW758	Brake wheel cylinders. Front & rear; 7/8" MORRIS 8, SE, Z van	£70.50

Brake Hoses

BP010	Hose to wheel cylinder adaptor 1/2" x 20tpi , 1/2" x 20 tpi Pre-S 10/4- 12/4- 10/6, Cowley etc	£7.26
BP020	Brake hose lock nut- 13/16" 26tpi AF, Morris 8 Series E	£2.24
BR040	Brake Hose M8 Rr, 10/4 S2&3 Fr & Rr, 12/4 S2 Fr & Rr,14/6 S2&3 Rr	£12.65
BR041	Brake Hose M8 Fr/ Rr , 10/4, 10/6, Cowley Fr & Rr(33-34), 10/4,10/6,12/4,15/6 Fr 11/16" ANF	£13.58
BR048	Brake Hose 11/16" ANFS x 16 both ends. 18.5" overall	£15.02
BR078	Brake Hose 7/16 X 20 male (2) & 5/8 x 26 female. 11.5" hex to hex	£12.14
BR080	Brake Hose Rear, Morris 8SE & Z van	£11.74
BR461	Brake Hose 7/16 X 20 male (2) & 5/8 x 26 female. 15.5" hex to hex	£12.14

morrisregisterspares.co.uk

Brake Fixings

Part No	Description	Price
BP004	Wheel Cylinder inner spring , 1.1/4" wheel cylinders	£5.76
BP010	Hose to wheel cylinder adaptor 1/2" x 20tpi thread, 1/2" x 20 tpi Pre-S 10/4- 12/4- 10/6, etc	£7.26
BP017	Brake shoe anchor E-clip. Replacement for the old "Horse shoe" type, all steel shoes	£0.60
BP018	Brake pull off spring rear (short), Morris 8	£5.28
BP019	Brake pull off spring front (long), Morris 8	£11.23
BP020	Brake hose lock nut- 13/16" 26tpi AF, Morris 8 Series E	£2.24
BP022	Thackray washer, Morris 8 brake shoe	£1.45
BP023	Brake drum screw 5/16" BSF x 3/4" CSK, Minor,8,8E, Z, 10/4 & 12/4 Series Cars, 8/10cwt	£0.72
BP024	Brake pull off spring, pre-series 10/4- 10/6, Cowley 4 rear	£7.92
BP025	Brake pull off spring, pre-series 10/4- 10/6, Cowley 4 front hub	£13.20
BP026	Brake drum screw Major pre series 10 /4 10/6 Cowley 4 and 6 Oxford 14 16 18 21 25 isis	£0.68
BP030	Copper Washer 7/16" ID	£0.24
BP031	Copper Washer 3/8" ID	£0.24
BP032	Copper Washer 9/16" ID	£0.29

Cooling -Hoses

HB205	Straight Hose 38mm x 205mm, Top Hose all Minors	£6.67
HB260	Bottom Hose, Morris 8, SE, Z van, including vans and GPO Minor, Late Minor	£8.26
HO011	Bottom hose OHC Minor	£9.59
HO021	Bottom hose SV Minor	£14.32
HO175	Top Hose, 8 series E 1939-48- Z van 1940-53 (Convuluted)	£9.95
HO326	Moulded Hose, Top Hose, Late Minor, 8 pre-series, Series 1 and 2	£10.58
HW001	Water Outlet Pipe- for cylinder head to top hose (with stud), Morris 8	£15.00

morrisregisterspares.co.uk

Cooling-Fan Belts

Part No	Description	Price
FB001	Fan Belt V113, B30, Fan belt OHC Minor	£11.88
FB002	Fan Belt: Morris 8 1935-1938, 12/4 S111 1938-1941	£7.20
FB100	Fan Belt B38, M8 Series E, Z Van all	£7.20
FB103	Fan Belt: Morris 14/6 1938-1939	£8.16
FB170	Fan Belt: Morris 10/4 Series M	£11.23
FB353	Fan Belt Morris 10/4 S111 1938	£8.78
FB432	Fan Belt Morris Twenty Five 6 cly 1939-1940	£9.01
FB930	Fan Belt B35, 10/4 pre series	£11.23

Electrical

DB038	Dynamo brushes, Series 2 14- 16- 18, 25, 1935-37	£1.13
DB096	Dynamo brushes, 10/4 1934/5, Isis 18hp 1930/33, Major 6 1931/33, Oxford 6 1930/34	£6.74
DB114	Dynamo brushes, 10/4 1933	£6.74
DB296	Dynamo brushes 25mm x 23mm x 8mm, 12/4, 15/6, Oxford Six 16hp & 20hp, 34 Isis	£11.23
DB364	Dynamo brushes, Morris 8 Series E, 10/4 series 3 and series M	£6.74
DB365	Dynamo brushes, Minor and Morris 8 S1 & S2, 12/4 Series 2	£6.74
SB126	Starter brushes, Minor OHV- Minor SV- early M8	£6.74
SB158	Starter brush spring, 20hp- Oxford 6 1935, 25hp 1933-55	£0.62
SB370	Starter brushes, M8 Series E, M10/4 Series 3	£8.83
SS755	Mechanical Switch as Lucas 51C, Early cars	£23.44
ST348	Starter brush spring	£0.30

morrisregisterspares.co.uk

Engine & Gearbox Mounts

Part No	Description	Price
ME002	2 front ribbed tapered insert & 2 circular pad 4 parts, 8 Series 1 & 2	£42.00
ME003	Gearbox mount rear, 1 & 2 , 10/4, 10/6, 12/4 , Cowley 4 & 6, 10cwt van	£29.99
ME004	Bolt for Engine mount front. 12mm dia, 98 mm long, 8 Series 1 & 2	£12.60
ME005	Engine mount, set of 4 rubbers, ten four & ten six	£46.54
ME140	Engine mount, set Minor pairs	£23.59
ME140A	Engine Mount Minor 1929-34 Front rubbers pair blocks 1.3/8" dia x 5/8" thick, OHC & SV	£10.80
ME140B	Engine mount Minor 1929-34 rear pair blocks 1.3/4" dia x 1" thick, OHC & SV	£10.56
ME147	Gearbox mount rear, 8 Series E	£29.99
ME311	Engine mount front, 8 Series E & Z	£23.76
RM001	Minor Engine Mounts	£24.00

Oil Pump

OG001	Oil Gauge pipe, All models	£15.84
OP093	Oil pressure Relief Valve; Spring & Ball, All Morris 8	£5.28
OS001	Oil Strainer Gauze 8 x 2.9/32, Requires soldering to fit Morris 8	£15.84

morrisregisterspares.co.uk

Engine Shells & Rods

Part No	Description	Price
BS339	Shell bearing set(R2), series E 8- MM Minor main bearings minus 20	£39.32
BS344	Big end shells minus 20, series E 8- MM Minor big end shells minus 20	£39.32
BS345	Big end shells minus 30, series E 8- MM Minor big end shells minus 30	£39.32
BS537	Main shells- std, series E 8- MM Minor, front and rear mains std	£39.32
CR001	M8 SE con rods ex WD, series E 8- MM Minor	£39.32
BE001	Big end bolt set, Morris 8 all models	£39.32

Engine-Studs, Bolts Nuts & Washers

BE002	Sump retaining bolt , Morris 8	£3.00
BE003	Sump bolt 30 mm, Morris 8	£3.32
ED029	Crankshaft starter dog ,male thread, All Morris 8, series M 10 and MM Minor	£10.80
SM085	Manifold studs 8 mm x 1 5/8" long, manifold to block, Morris 8 and most series 2 / 3 models	£3.30
NM103	Manifold nut M8 20 mm long	£1.14
NM103a	Manifold nuts 1.3 inches long Morris 8 and most other models	£1.19
NM104	Manifold nut; Minor	£1.66
NX006	Manifold nuts 8mm x 2 inches long, Series E&Z	£1.66
SM095	Exhaust Flange studs- manifold to exhaust pipe 3/8" BSF x 1.5" long, Morris 8 Series 1 & 2	£5.63

Engine-Tappet Screws

ST001	Tappet Screw, hardened with nut, all SV models except Minor	£5.28
ST002	Tappet screw, Morris 10 & 12 series 3 and 10 series M	£5.28
ST003	Tappet Screw-case hardened as per original, Morris 8	£2.18
ST004	Tappet screw- no lock nut, either ST001 or ST003	£1.20
ST001	Tappet Screw, hardened with nut, all SV models except Minor	£5.28

morrisregisterspares.co.uk

Cylinder Head Studs

Part No	Description	Price
SH001	Cylinder head studs, Series M 10/4	£4.62
SH002	Cylinder head studs 12mm dia, Oxford and Cowley long (set is 3 long and 12 short)	£2.40
SH003	Cylinder head studs 12mm dia, Oxford and Cowley short (set is 3 long and 12 short)	£2.40
SH005	Cylinder Head stud with 8mm threaded extension to hold air cleaner plus long nut, pre-series	£6.48
SH006	Cylinder Head Stud 10mm x 3.1/8" long M8, SE, Z van, 14/6, 16/6, 18/6 +more EN16 HT Steel	£1.75
SH007	Cylinder Head Stud 10mm x 3.1/2" long Y van, 10/4, 12/4, 10/6 EN16 HT Steel	£1.75
SH008	Cylinder Head Stud 10mm x 2.1/2" long (HT), 8 series E&Z, 4 positions EN16 HT Steel	£1.75
SH009	Cylinder Head Stud 10mm x 72mm , M8 short stud EN16 HT Steel	£1.75
SH010	Cylinder Head stud set (13 studs) Morris 8 1934-1938 EN16 HT Steel	£19.99
SH011	Cylinder head stud set (13 studs) , Series E & Z Van EN16 HT Steel	£19.99
SH012	Cylinder Head Stud M10, M8, SE, Z Van, Special Extra Long 106mm EN16 HT Steel	£1.75
SH482	Cylinder Head Stud 5/16" BSF x 2.5/8" long (short), SV Minor 14 per engine	£3.30
NH001	Cylinder head nuts, 10mm, 12mm tall, M8 ,SE, Z van, M10	£1.13
WH001	10mm Washer For Cylinder head studs (not originally fitted)	£0.60

morrisregisterspares.co.uk

Engine-Timing Chains

Part No	Description	Price
TC050	Timing Chain 50 links duplex, All Eights, inc SE and Z van	£10.00
TC052	Timing Chain, SV Minor 1930-1934. 11.9 hp Cowley 1933	£10.39
TC058	Timing Chain Cowley 4 1934; 12/4 series 2 & 3, 1935-39; 14/6 series 2 & 3, 1937-39; 16, 18/6	£11.59
TC060	Timing Chain 60 links duplex, 10/4 series M	£11.99
TC064	Timing Chain Pre-Series 10/4, 10/6, Series 2 & 3 10/4 1933 - 38. 12 hp 12/6 1934	£12.79
TC072	Timing Chain (made to order) 21/6 series 2, 25/6 series 2 & 3, 1935-39	£14.39
TC090	Timing Chain (made to order) Oxford 6 1930-35; Cowley 6 1934, Major 6 1931-33; 15/6 1935	£17.98
TC094	Timing Chain; (made to order) Oxford Twenty 1935, Oxford 6 16 hp 1933-44	£18.78
TC126	Timing Chain (made to order) Morris 17.7 / 18 hp, Six 1928-29 & Isis 6,1930-35, JA/ K6	£25.18

Valve Guides

VG006	Valve Guide Cast Iron, Minor SV	£5.76
VG008	Valve Guide , Morris 8, all models and Morris 10-6	£5.99
VG015	Valve Guide Cast Iron, M 10/4 side valve 1933-37, L series, Oxford 1930-32, Major, Cowley	£7.92

Valve Springs

VS106	Valve Spring Single, 10/6 SV	£4.80
VS198	Valve Spring SV Minor	£4.80
VS200	Valve spring Double, Morris 8 all models	£3.96
VS201	Valve Spring Single, M 10/4 side valve 1933-37, L series engines Oxford 1930-32, Major, Cowley	£4.36
VS333	Valve Spring Single, Morris 8 all models	£4.75

morrisregisterspares.co.uk

Engine-Valves

Part No	Description	Price
VE 417	M12/4 SIII inlet. Tranco 1140- James 1982.	£10.56
VE009	Morris 8 all models. inlet / exhaust valve	£8.99
VE017	C type 25 hp 6 Cyl Exhaust Tranco 2017 1935 -38.	£2.40
VE020	1933/34 Ten, Ten Four, Major, Cowley Six, Tranco 507 circular groove.	£10.00
VE028	11.9 HP Cowley 1931- 1932, XB505 TT10 horseshoe cotter groove.	£7.20
VE034	Tranco 1034- parallel groove, Ten Four 1935 and Series II.	£10.90
VE141	Tranco 1141. New old stock, M12/4 SIII exhaust valve.	£10.56
VE154	10/6 IN/EX. 1934/5 parallel groove. Tranco 1172	£5.28
VE174	Tranco 1174- James B1985. M10 SIII Exhaust.	£7.92
VE180	Tranco 2180 Wolseley Twenty-One SII Exhaust Valve	£2.40
VE194	1935 Morris 25/6 Valve	£6.00
VE281	M10 SIII inlet valve Tranco 1173- Mowog 20030 VL.	£7.92
VE315	Series M 10/4 inlet Valve	£7.92
VE316	Series M 10/4 Exhaust Tranco 1984- VK+ 1989.	£7.92
VE503	Minor sv. Tranco 503 parallel groove.	£11.88
VE816	932 - 34 Morris Com 17.9 4 Cyl D- DL- DS Tranco 816- James 71	£2.40
VE821	Morris Comm 13.9 4 Cyl L2- T2.Tranco 821- James 2603, Mowog2233. , 1935 - 38	£2.40
VE835	1934 Cowley Four Tranco 1030- circular groove,	£13.48
VE911	Series II 14/6. Tranco 911- James VK+ 1569.	£6.00
VE980	Major 1931- 33, Oxford 6 1930 -32. Tranco 980- horseshoe cotter. shop soiled, slight rust,	£6.00
VE991	Ten Six 1934 parallel groove 1935) Tranco 512- circular groove.	£10.80
VE997	Morris Series 111 25/6 Exhaust Valve	£9.60
VE998	Morris Series 111 25/6 Valve	£2.40

morrisregisterspares.co.uk

Oils

Part No	Description	Price
GFG001	Golden Film AG140 Classic Gear Oil ; 1 litre	£14.18
AGN 001	Golden Film AG 90 Gear Oil & 1 litre ; Morris oils	£11.82
GFH 001	Golden Film SAE 30 Classic Motor Oil 1 litre ; Morris oils	£10.51
GFH 005	Golden Film SAE 30 Classic Motor Oil ; 5 litre ; Morris oils	£31.50
SW030	Copper Sump Washer; Engine & Gearbox, All 8's SE, Z van, 10's,12's, 14's with 30mm drain plug	£0.60

Fuel Pump

AUA1469	SU Fuel Pump Cap ; Brown (6V)	£4.58
AUA25	Fuel Pump 12 Volt Bulkhead mounted. Dual Polarity	£84.60
AUA26	Fuel Pump 6 Volt Bulkhead mounted, M8 ,SE, Z Van: Dual Polarity	£89.99
AUB6098	SU Fuel Pump Diaphragm Assembly, M8, SE, Z Van, M10	£23.45
AUC2141	Fibre Washer SU, Fuel Pump & Carb Banjo	£0.54
EPK700	Service kit SU Fuel Pump contains; diaphragm, points, filter, gaskets, seals, rollers, spring.	£32.12
FP022	Fuel pump contact set, All SU Fuel Pumps, all Morris's 1934 - 1953	£10.99
FP634	Fuel pump pedestal, All SU Fuel Pumps, all Morris's 1934 - 1953	£7.36
WZX911	Fuel Pump Pipe Elbow	£8.57

morrisregisterspares.co.uk

Carburettor

Part No	Description	Price
AUC1412	SU Float Chamber Gasket M8, SE, Z Van, 10/4, 10M	£0.52
AUC1534	Float chamber grommet	£1.32
AUC2141	Fibre Washer SU, Fuel Pump & Carb Banjo	£0.54
AUC2144OR	Dashpot screw cap, All SU H type carburettors, all Morris's 1930 -1953	£12.04
AUC8182	H Type Standard Jet Assembly .090in, all Morris's 1930-1953	£9.35
CK004	Dashpot screw cap, All SU H type carburettors, all Morris's 1930 - 1953	£8.99
CK006	Float Chamber tickler kit, All SU H type carburettors, all Morris's 1930 -1953	£10.56
CK013	Split pin, All SU H type carburettors, all Morris's 1930 -1953	£0.12
CK018	Washer kit, contains 14 assorted seals, SU H type carburettors, all Morris's 1930 - 1953	£9.16
CK101	Float needle and seal kit, All SU H type carburettors, all Morris's 1930 -1953	£7.80
CK139	Float chamber banjo bolt filter and spring, SU H type carburettors, all Morris's 1930-1953	£5.02
CK267	Carburettor rebuild kit M8 1934-1938	£61.74
CK595	Jet kit, All SU H type carburettors, all Morris's 1930 1953	£14.16
CK698	Float chamber- zinc plated banjo bolt, All SU H type carburettors, all Morris's 1930 - 1953	£6.60
CRK226	SU H1 Carburettor rebuild kit M8, SE, Z Van, M10 1938-1953	£54.20
CSK40	Service Kit ; For H1 Carburettors, Morris 8, SE & Z Van, M10 193347	£34.20
GC101	GC101- Morris 8, SE, Z Van Carburettor Insulating Gasket	£1.99
KD276	Gasket Carburettor to manifold, Morris 8 p- series 1 & 2	£0.78
VZx1101	SU Carburettor Needle & Seat Kit, M8,SE, Z van, M10	£7.86
WZX 1302	Float Kit. Suitable for H1 & H2 Carbs. M8, SE,Z Van, M10	£22.24
WZX911	Fuel Pump Pipe Elbow	£8.57
CK002	Needle Standard Morris 8 1934-1938	£10.14
CK003	Std needle Morris 8SE & Z Van 1938-1953	£8.58

morrisregisterspares.co.uk

Head Gaskets

Part No	Description	Price
GH810	Head Gasket (was also GH154), 4-38 Cowley Four, 12/4 pre-series & series 2 12/4 and 10cwt van	£42.00
GH510	Head Gasket 1923/33 Cowley 11.9hp	£44.22
GH361	Head Gasket , 1933 - 1937 Ten Four SV	£60.48
GH250	Head Gasket , 1938-48 Eight Series E , Z van & 1948 - 53 MM (swaged water apertures)	£39.98
GH269	Head Gasket , 1939/48 series M 10/4	£39.98
GH979	Head Gasket , L series engines, 1930-32 Oxford, 31 -; 33 Major, 34 Cowley Six, 1935 15/6	£55.44
GH867	Head Gasket , 1929 - 32 OHC Minor	£36.00
GH161	Head Gasket 1930/34 SV Minor	£48.18
GH950	Head Gasket Copper , 1938-39 10/4 Series 3 ohv	£43.20
GH680	Head Gasket Morris 8 S1/2 UB Engine (swaged perimeter water apertures)	£39.98
GH597	Head Gasket Morris Ten Six (Payen 1597)	£49.20

Manifold Gaskets

GM469/3	Manifold Gasket 3 pieces, 1931 -34 SV Minor	£17.16
GM940	Manifold Gasket, 12/4 Series 3	£4.80
GM270	Manifold Gasket, 1934-38 Cowley Four, 12/4 pre-series & series 2 12/4 and 10cwt van to 1950	£1.20
JA214	Manifold Gasket, round ports, Series 1 & 2 8	£5.40
GM495	Manifold Gasket, Series 3 14/6	£1.40
GM269	Manifold Gasket, Ten Four series M 1939 & #8211; 48	£5.28
GM469/1	Manifold gasket SV Minor (1 piece, replaces 3 piece), 1931 - 34 SV Minor	£12.36
GM104	Manifold gasket, 1933 - 1937 Ten Four side valve	£7.26
JA235	Manifold Gasket, two square ports, Series E & Z 8	£5.70
GM983	Manifold to Block, Morris Ten Six	£8.58

morrisregisterspares.co.uk

Other Engine Gaskets

Part No	Description	Price
GS004	Sump Drain Plug, 10/4- 10/6- Cowley etc.	£0.66
GS001	Sump gasket cork, Pre-series 10/4- 10/4 Ser 2, Series 3, MG TA	£7.92
GT600	Tappet cover cork strip, SV Minor	£6.73
GV056	Tappet cover gasket cork, 1933- 1937 Ten Four side valve	£4.32
GV057	Tappet cover gasket cork, 1934-38 Cowley Four, 12/4 pre-series & series 2 12/4, 10cwt to 1950	£3.30
JM215	Tappet cover gasket cork, All Morris 8	£5.04
GT002	Timing chain cover gasket, 10/4 pre-series	£4.80
GS250	Bottom end gasket & Seal set (conversion set) All M8's, SE & Z van	£26.50
GS002	Cork Sump gasket, Side Valve Minor	£6.60
GA001	Diff Gasket Minor 8 , SE MM & Z Van; GA001	£3.60
GG001	Exhaust Manifold flange Gasket SE & Z van	£2.99
GE002	Exhaust flange gasket, ring olive type, Payen 2231, 1931-32 Minor(early)	£7.60
KK110	Exhaust flange to manifold gasket (3 studs), Morris 8 Series 1 and 2, 10/4, 12/4 pre-series, series	£5.78
GM288	Exhaust gasket Minor	£3.36
SW030	Copper Sump Washer; Engine & Gearbox, All 8's SE, Z van, 10's,12's, 14's with 30mm drain plug	£0.60
GW390	Water outlet pipe on Cylinder head, Morris 8 series 1 & 2. Late Minor	£2.16
GW008	Water Inlet Elbow to side of block, All Morris 8	£1.44
EH001	Exhaust collar, steel- tapered, Morris 8 1935 – 38 and 1935-6 10/4- 10/6- 12/4	£11.28
GC101	GC101- Morris 8, SE, Z Van Carburettor Insulating Gasket	£1.99

morrisregisterspares.co.uk

Ignition

Part No	Description	Price
CI012	12v ignition coil, New, with screw connectors, New- with screw connectors	£21.12
CL006	6v ignition coil, New, with screw connectors, All Minors & Eights	£14.99
DC045	Distributor cap, For DKY4A & D2A4 Distributors.	£28.20
DC056	Distributor cap, top entry, for distributor with metal base plate.	£14.10
DC160	Distributor cap, for DK type distributors.	£17.63
DR001	Base plate, to suit DK4A/DK6A distributors	£24.67
DR002	Pin for distributor drive dog, All distributors	£0.24
DR033	Rotor Arm Morris 8 & 8 series E 35-48, 10 series M 1938-48, series 3 12/4 38-40	£4.99
DR034	Rotor arm DK4A- DKH4, DKH4A, DKY4A (anti-clockwise). Lucas 400052/405469, 10/4 SV 1934	£3.53
DR035	Rotor Arm for DK6A distributor, 10/6 1935, Oxford 16, series 2 14, 16,18, 21, 25, 19	£6.60
DR050	Points for DKYH4A distributor; 8 series E, 10 series M 1946 on	£8.46
DR060	Rotor Arm for DJ4, DJ4A, DJ6, DJ6A, DJH4, DJH4A distributors.	£10.57
DR102	Washer, split copper washer for acorns, all distributor caps/ coils	£0.46
DR308	Condenser All 8s SE, Z van All 10s most other models	£10.57
DR415	Points for DK4A, DK6, DK6A, DKH4, DKH4A, all models 1934-46	£10.57
DR833	Points for DJ4- DJ4A, DJ6, DJ6A, DJH4, DJH4A distributors.	£10.54
EX008	Spark Plug Ten Six 1935 chassis 35186→ NGK Number: B6S	£2.04
Ex014	Spark Plug Cowley 1915-1934 inc 12/4, 6, 15/6	£3.59
EX082	Spark plug NGK B9ES 1934 ten 6	£3.19
EX086	Spark Plug All 8s SE & Z van	£2.40
EX86S	NGK Spark Plug, Set of 4 All 8's SE & Z van, 10 S11, 111 &M	£8.94

morrisregisterspares.co.uk

Suspension

Part No	Description	Price
SA006	Shock absorber, Small pivot pin kit, small PEAR shock absorbers	£13.48
SA007	Shock absorber, Large pivot pin set, large PEAR shock absorbers	£13.48
SB001	Spring rebound buffer long, 1 1/2" overall, 1 1/16" above base, Minor, 8 Series 1 & 2	£0.62
SB001a	Spring rebound buffer short, 7/8" overall, 8 Series E and 10 series M	£0.62
SP001/2	Shackle Plate 2.15/16" centre, 1/2" holes, pair, one plain, one with pin stop, M8 35-38 FR	£21.12
SP009/ 10	Shackle pin and bush, threaded, Morris 8E- 10 series M. Pair with SP010.	£28.98
SP030	Shackle Pin, 2 5/8" long, wing Head, Rear of front spring Morris 8	£14.20
SP035	Folded Shackle, Minor front and rear (4 required); 8 Series 1 & 2 rear (2 required)	£21.78
SP087	Shackle Plate 2.1/8" centres- 2 tapered holes 1/2" to 7/16". shop soiled, half price, 8E series	£3.60
SP087ME	Shackle Plate Similar to SP087- but hole tapers 7/16 to 9/16" shop soiled, half price.	£7.80
SP088	Shackle Plate 2.1/8" centres- one 1/2" hole, one tapered 1/2 to 7/16", 8 series E early	£14.52
SP088ME	Shackle Plate Similar to SP088- but holes taper 7/16 to 9/16". shop soiled, half price	£4.80
SP089	Shackle Plate 2.1/2" centres- one 7/16" hole, one tapered 1/2 to 7/16" shop soiled half price,	£6.00
SP089 ME	Similar to SP089- but hole tapers 7/16 to 9/16". shop soiled, half price	£6.42
SP347	Shackle pin, 2 3/16" long, wing head	£13.20
SP368	Shackle Pin. 2 5/8" long, Cheese Heed	£18.48
SP501	Shackle Pin, 2 7/16" long, Wing Head	£14.40
SP502	Shackle pin, 3 3/16" long, Cheese Head	£14.40
SP523	Shackle pin, 2 3/4" long, threaded, hexagon head	£17.16
SP525	Shackle bushes, rubber, Morris 8 series E, 10 series M	£1.44
SP593	Shackle pin, 3 1/2" long, threaded, hexagon head,	£14.40
SP622	Shackle pin, Series E & Z 8	£6.60
SP888	Shackle pin, 2 7/8" long, Cheese Head,	£15.48

morrisregisterspares.co.uk

Suspension continued

Part No	Description	Price
SP930	Shackle pin, 3" long, Cheese Head	£14.20
SP987	Silent bloc bush 0.875" O/D, front of rear spring Morris 8 series E	£9.36

Transmission

CP001	Clutch release bearing carbon Morris 8 all models	£18.00
CP009	Clutch kit for Morris 8, SE, Z Van 1935-1955, includes; plate, cover & release bearing	£64.99
FC055	Hardy flexible disc type universal joint, large, 10/4 and 10/6 1933- 35	£58.20
FC058	Hardy flexible disc type universal joint, small, OHC & SV Minor and early Morris 8	£54.07
OS108	Gearbox output shaft seal- steel cased neoprene, Ten Four, ten six chassis 14931 1934 on	£10.80
QL152	Universal joint, all Morris 8s, 10s & 12s 1935 onwards	£8.40
SC001	Speedo Cable 57" disc type speedo head, Minor- 8 to chassis 72145- 10/4, 10/6, 1933-Male	£43.56
SC002	Speedo Cable 57" long needle type speedo. M8 after chassis 72146- 1937-38 10s- 14s.	£43.56
SC003	Speedo Cable 56" long, Morris 8 series E & 10M & Y van, Z van	£45.00
SG014	Speedo gears, 14 teeth, Oxford- 1925 - 29 FWB models	£12.00

Various Parts

654	Bifurcated copper split rivet-pack of 10	£1.92
DH400	Chromium plated, locking T handle, oval escutcheon, centres 1.75" apart, Boot handle, 8 SE	£15.84
DH596	Carriage key, polished iron, 3.5" long, to suit square drive budget latches, 8 series E bonnet	£5.99
DH597	Carriage keys (No.5) As DH596, but 5" long, for better grip, 8 series E bonnet	£4.79
DH600	Non-locking door handle to match DH950 1 3/4" centres, Morris 8 Series 1 & 2,	£15.84

morrisregisterspares.co.uk

Various continued

Part No	Description	Price
DH651	Non-locking door handle to match DH654, Morris 8E- 10M 1939 -48	£26.40
DH654	Chrome plated locking door handle, heart-shaped escutcheon, Morris 8E- 10M 1939 -48	£33.00
DH863	Replacement die cast lock cylinder (barrel) with two nickel-plated d keys, Most door handles	£9.54
DH950	Chromium plated, outside locking door handle & 2 keys, oval escutcheon, centres 1.75", 8 Series 1	£19.80
NX008	Chromed Bumper Nut and Bolt, Morris 8 Series 1 & 2	£4.62
RM006	Oval Pedal Rubber embossed with M, all Morris 8s Z van, over 8 hp Ser 2 & 3, 10 series M	£5.28
RM007	Rubber gearbox cover, 8 Series E, 10 series M	£39.60
RM008	Rubber gearbox cover, Morris 8, pre-series, series 1 and 2	£39.60
RM009	Rubber bonnet corner 60 degrees, Morris 8 series 1 & 2, over 8hp ,models series 2 & 3,	£2.28
RM010	Rubber bonnet corner 90 degrees, Morris 8 series 1 & 2, over 8hp, models series 2 & 3,	£2.39
RM018	Rubber Gear Lever Gaiter	£6.96
RM020	Pedal rubber, brake or clutch, 1934 Oxford, 16/20 Cowley 4	£9.60
RM021	Circular Pedal Rubber , 1930-33 models, 10/4 Oxford 6, Major, Isis, 25, 8-10cwt van	£7.92
RM444	Morris 8 SE Fuel Filler Grommet	£22.79
SF100	1/4" BSF countersunk floorboard screw 1" long, All models	£0.66
SF125	1/4"; BSF countersunk floorboard screw 1.25"; long, All models	£0.66
WB351	Wiper Arm to suit 3/16";wiper motor shaft, Chromed- adjustable length from 6 "to 7.1/2"	£21.12
WB370	Retaining Carrot for Wiper arm,	£0.66
WB370H	Wiper blade hook type 10"	£5.94
WB370s	Wiper Blade 8" flat	£6.60
WF001	Countersunk washers for floorboard screws, All models	£2.64
WT004	Hub Cap Screw, High polished stainless, Male thread to hold all caps from 1933 to 1938	£5.94

morrisregisterspares.co.uk

How to purchase spares

Ordering Online simple and Safe

You can pay online with a debit or credit card through the secure PayPal gateway, it is not necessary to have a Pay Pal account.



Product Categories

- **NEW PRODUCTS** (30)
- Aides (148)
- Bearings (34)
- Brakes (37)
- Cooling (37)
- Electrical (34)
- Engines (115)
- Fuel (37)
- Gaskets (30)
- Ignition (32)
- Oil (36)
- Suspension (29)
- Transmission (35)

The Register's Spares Service



We aim to provide a service that will help members keep their Morris in good fettle and suitable for safe and enjoyable motoring.

The Shop is run by Lindsay and David Smith in their own free time. They are not equipped to go into detailed discussions with members as to which is the correct part for their car. The information given in the descriptions in this shop should be sufficient to identify the parts you need.

If you are not sure what the correct part is, then please put a request for help onto the Forum.



VAT will automatically be charged **ONLY** if spares are despatched to **EU countries**. The website will work this out based on shipping destination. This list includes prices with VAT.

Shipping is at fixed cost; currently £3.99 for the UK £5.99 Rest of Europe £6.99 Rest of the world £12.99. The website will work this out based on shipping destination

New products are frequently being added, check the "new products" category on the website.

morrisregisterspares.co.uk

morrisregisterspares.co.uk

Spares Identification Help Charts

The following charts are available on the Spares Website to help members in identifying the correct parts

- Bearings
- Brake Hoses
- Brake Cylinders & Kits
- Brake Linings
- Brake Cables
- Radiator Hoses
- Carburettor Needles
- Distributor Caps
- Distributor Parts
- Fan Belts
- Shackle Pin & Plates
- Timing Chains
- Engine Valves
- Wheel Studs
- Spark Plug Info

morrisregisterspares.co.uk

Notes

About

We aim to provide a service that will help members keep their Morris in good fettle and suitable for safe and enjoyable motoring.

The Spares Service is run by volunteers in their own free time. We may not always be available to go into discussions with members. Online ordering massively reduces the time the clubs volunteer's spend supporting this service, and we appreciate members using it.

If you are unsure about the correct part required, then please put a request for help onto the Clubs Forum. There will always be members online who will be able to share their knowledge with you. The online shop also has many help charts to assist with identifying the correct parts.

If you are a manufacturer or supplier who could supply us with current or new products, or have some NOS that you wish to dispose of please contact us.

email: spares@morrisregister.co.uk

morrisregisterspares.co.uk

All prices include VAT Check the website for availability & Latest prices